

# 鎢鋼螺旋銑牙刀-BSP(G) (內牙/外牙)

Carbide Thread Milling Tools-Helical Flutes-BSP(G) (Internal / External)

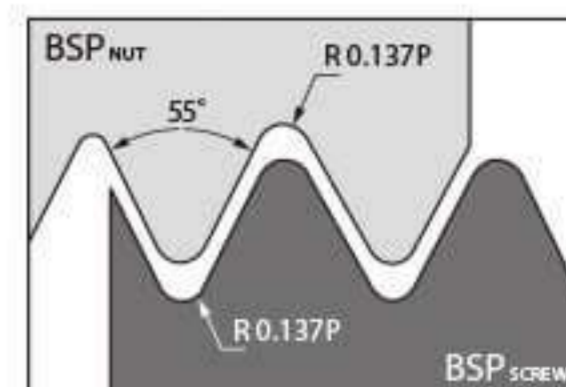

編號 (Number)	牙尺寸 (Thread Size)	螺距 (Pitch)	外徑 (D)	牙長 (H)	刃數 (T)	柄徑 (d)	全長 (L)	齒數 (Zt)	底孔尺寸 (mm)	價格 (Price)
JFB2806	1/16", 1/8"x28	28	5.8	16.3	3	6	60	18	6.7	
JFB2808	1/8"x28	28	7.7	20	3	8	60	22	8.7	
JFB1910	1/4", 3/8"x19	19	9.9	26.7	4	10	75	20	11.8	
JFB1412	1/2", 3/4"x14	14	11.9	22.7	4	12	75	16	19.0	
JFB1916	3/8"x19	19	13.4	33.4	4	16	100	25	15.2	
JFB1416	1/2", 3/4"x14	14	15.7	43.5	4	16	100	24	19.0	
JFB1116	1", 1 1/2", 2", 2 1/2"x11	11	15.9	43.5	4	16	100	19	30.7	
JFB1120	1", 1 1/2", 2", 2 1/2"x11	11	19.9	41.6	4	20	100	18	30.7	

# 鎢鋼螺旋銑牙刀-BSPT(Rc) (內牙/外牙)

Carbide Thread Milling Tools-Helical Flutes-BSPT(Rc) (Internal / External)

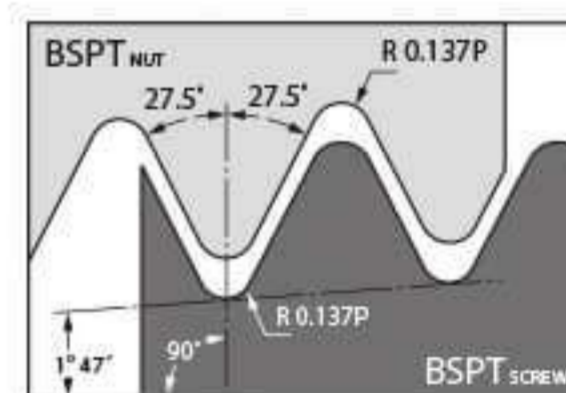
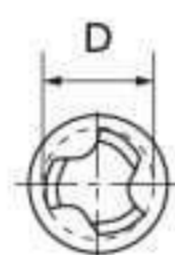

編號 (Number)	牙尺寸 (Thread Size)	螺距 (Pitch)	外徑 (D)	牙長 (H)	刃數 (T)	柄徑 (d)	全長 (L)	齒數 (Zt)	底孔尺寸 (mm)	價格 (Price)
JFR2806	1/16"x28	28	4.89	16.3	3	6	60	18	6.7	
JFR2808	1/8"x28	28	6.48	20	3	8	60	22	8.7	
JFR1910	1/4"x19	19	8.28	26.7	4	10	75	20	11.8	
JFR1412	1/2", 3/4"x14	14	10.54	22.7	4	12	75	13	19.0	
JFR1916	3/8"x19	19	11.37	33.4	4	16	100	25	15.2	
JFR1416	1/2", 3/4"x14	14	13.12	43.5	4	16	100	24	19.0	
JFR1116	1", 1 1/2", 2", 2 1/2"x11	11	13.96	32.1	4	16	100	14	30.7	
JFR1120	1", 1 1/2", 2", 2 1/2"x11	11	17.38	41.6	4	20	100	18	30.7	